

Morgan Crossing Business Park

Building 2
3088 Croydon Drive



Highlights:

- Brand new commercial office building
- Central location with easy access to Highway 99 and the US Border
- Excellent Parking
- Ample amenities nearby

Contact:

604.510.5555

Ryan Schwartz *
ryan@fvcre.com



RE/MAX Commercial Advantage
#202 - 15127 - 100 Avenue
Surrey, BC, V3R 0N9

* Personal Real Estate Corporation

Each Office is Independently Owned & Operated

For more information visit: www.fvcre.com

OFFICES FOR LEASE

Morgan Crossing Business Park

Building 2
3088 Croydon Drive

Morgan Crossing Business Park is conveniently located at Croydon Drive and 31st Avenue in South Surrey.

It's easily accessible from both 32nd Avenue Diversion and 152nd Street and is adjacent to Highway 99 providing exposure to Highway 99's southbound traffic.

This brand new office building is conveniently close to amenities such as Save On Foods, Canadian Tire, Staples, Starbucks and many more that will meet all your business needs.



Location

Contact:

604.510.5555

Ryan Schwartz *
ryan@fvcre.com

* Personal Real Estate Corporation



RE/MAX Commercial Advantage
#202 - 15127 - 100 Avenue
Surrey, BC, V3R 0N9

Each Office is Independently Owned & Operated

For more information visit: www.fvcre.com

OFFICES FOR LEASE

Morgan Crossing Business Park

Building 2
3088 Croydon Drive

Opportunity

Building 2 at Morgan Crossing Business Park is a brand new commercial office building with 2 floors of professional space.

Availability

Level 1 Base Rent: \$28.00 per sq.ft.
Level 2 Base Rent: \$25.00 per sq.ft.
Operating Costs: \$10.00 per sq.ft. (est)

Availability

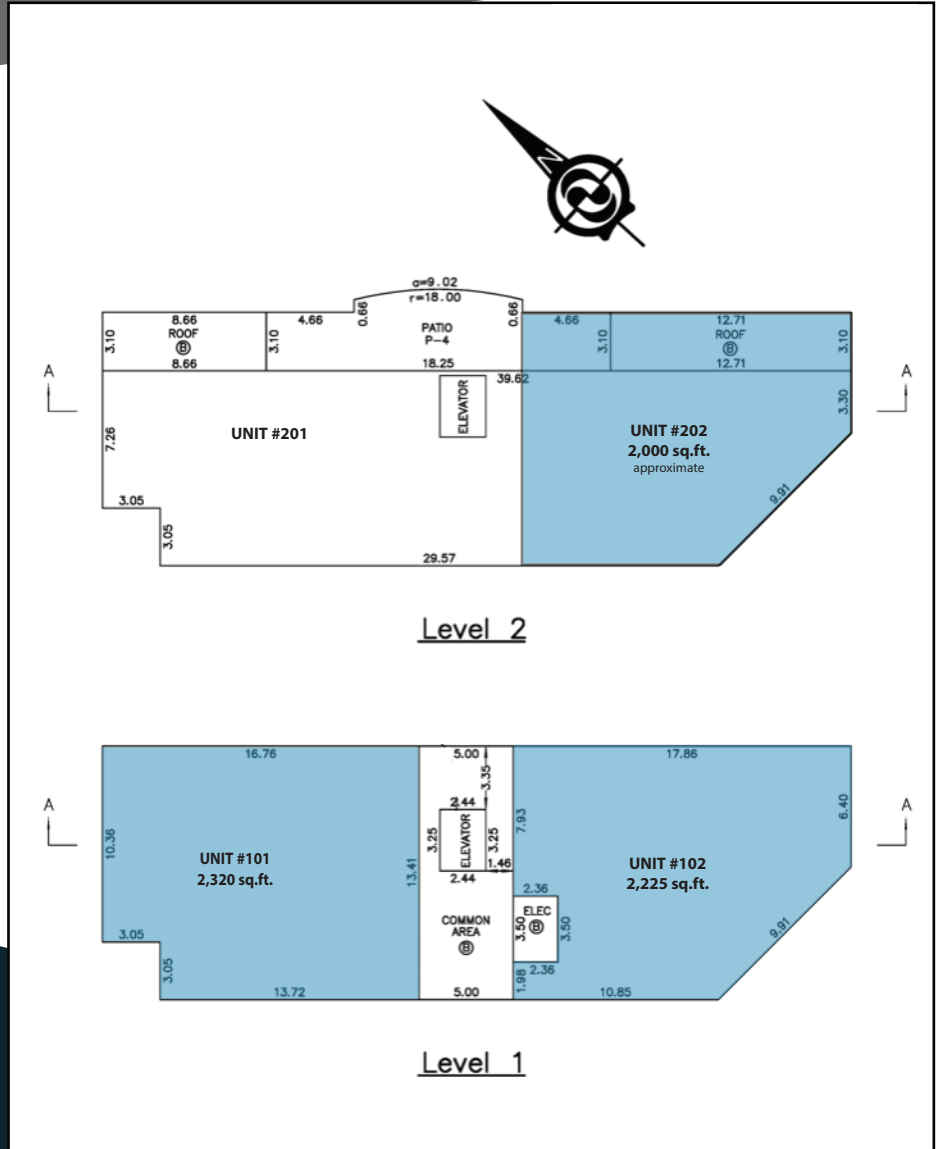

Contact:

604.510.5555

Ryan Schwartz *
ryan@fvcre.com



RE/MAX Commercial Advantage
#202 - 15127 - 100 Avenue
Surrey, BC, V3R 0N9

* Personal Real Estate Corporation

Each Office is Independently Owned & Operated

For more information visit: www.fvcre.com