

*fraser valley*  
COMMERCIAL

# FOR LEASE

33623 Wildwood Drive  
Abbotsford



## Highlights:

- High exposure location
- Easy access to Abbotsford's main thoroughfare & Highway #1
- Close to Public Transit
- Ample parking (underground & surface)

Contact:

**604.510.5555**

Gordon MacPherson \*  
gordon@fvcre.com

Ryan Schwartz \*  
ryan@fvcre.com



RE/MAX Commercial Advantage  
#403 - 15127 - 100 Avenue  
Surrey, BC, V3R 0N9

\* Personal Real Estate Corporation

Each Office is Independently Owned & Operated

For more information visit: [www.fvcre.com](http://www.fvcre.com)

33623 Wildwood Drive  
Abbotsford

## Opportunity

Located across the street from the former MSA hospital, which is up for tender to build a large congregate care facility. The new interchange is now complete at McCallum with the new Cabelas opening in June, 2016. Close proximity to the University of the Fraser Valley Campus and Abbotsford event centre (approximately 7 blocks).



Contact:

**604.510.5555**

Gordon MacPherson \*  
gordon@fvcre.com

Ryan Schwartz \*  
ryan@fvcre.com



RE/MAX Commercial Advantage  
#403 - 15127 - 100 Avenue  
Surrey, BC, V3R 0N9

\* Personal Real Estate Corporation

Each Office is Independently Owned & Operated

For more information visit: [www.fvcre.com](http://www.fvcre.com)

33623 Wildwood Drive  
Abbotsford

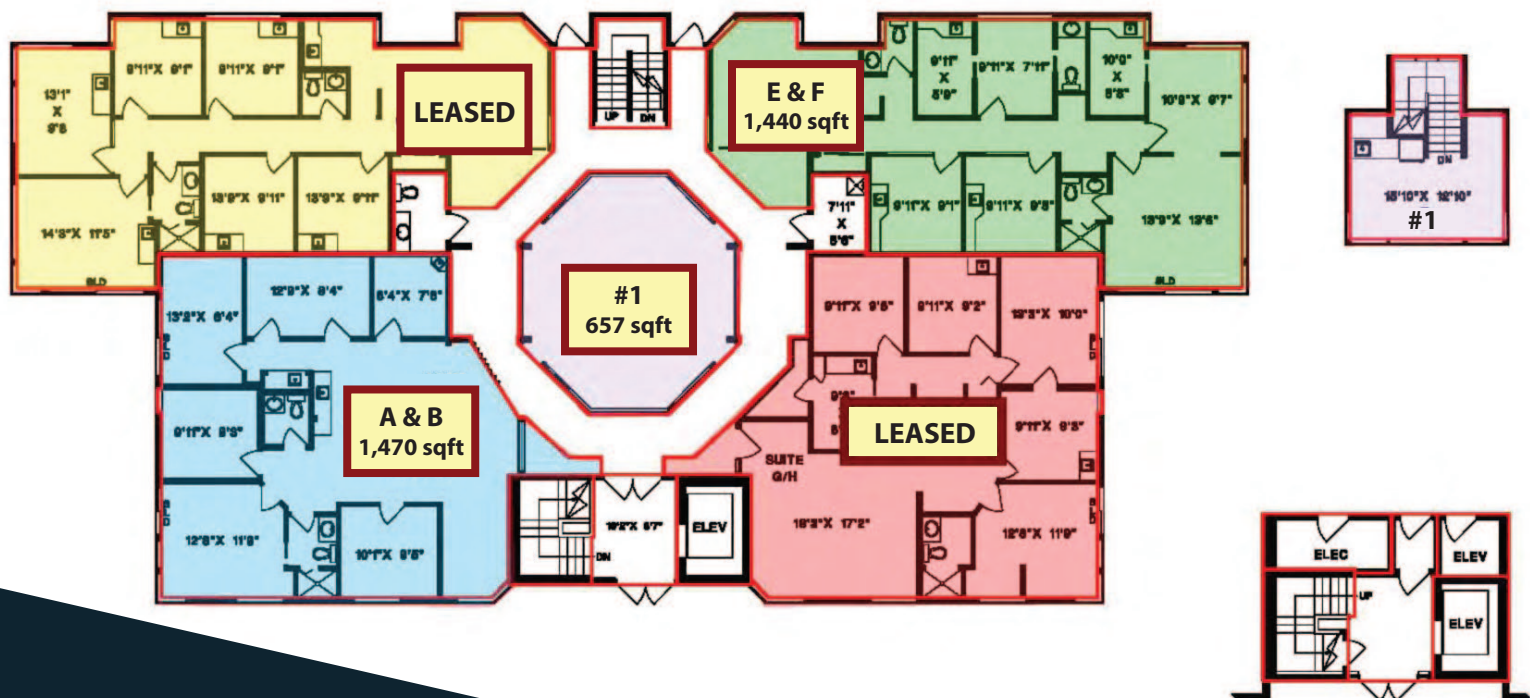

## Availability

#A&B	1,470 sqft
#C&D	LEASED
#E&F	1,440 sqft
#G&H	LEASED
#1	657 sqft

Base Rent: \$13.00 psf  
Additional Rent: \$ 7.50 psf

Contact:

**604.510.5555**

Gordon MacPherson \*  
gordon@fvcre.com

Ryan Schwartz \*  
ryan@fvcre.com



RE/MAX Commercial Advantage  
#403 - 15127 - 100 Avenue  
Surrey, BC, V3R 0N9

\* Personal Real Estate Corporation

Each Office is Independently Owned & Operated

For more information visit: [www.fvcre.com](http://www.fvcre.com)