

the mark



## Highlights:

- Brand new building with quality steel construction
- Corner location near transit
- 30,000+ vehicles per day on South Fraser Way
- Ample parking

[themarkabbotsford.com](http://themarkabbotsford.com)

## Contact:

**604.510.5555**

Gordon MacPherson \*  
[gordon@fvcre.com](mailto:gordon@fvcre.com)

Ryan Schwartz \*  
[ryan@fvcre.com](mailto:ryan@fvcre.com)



RE/MAX Commercial Advantage  
#202 - 15127 - 100 Avenue  
Surrey, BC V3R 0N9

\* Personal Real Estate Corporation

Each Office is Independently Owned & Operated

For more information visit: [www.fvcre.com](http://www.fvcre.com)

the mark

**Address:**

North Bldg: 32625 South Fraser Way  
South Bldg: 32615 South Fraser Way

**Site Size:**

69,191 sq.ft., 1.58 Acres

**Zoning:**

C5 (City Centre Commercial)

**Operating Costs & Property Taxes:**

\$9.00 per sq.ft. per annum

**Opportunity:**

The Mark is an affordable opportunity for an owner/user or investor to purchase brand new office or retail space. The Mark is located on a 1.5 acre parcel in the heart of Abbotsford's commercial district. This 68,000 sqft steel and concrete complex features 220 parking stalls (mix of surface and underground parkade); views of the city and surrounding mountains; individual climate-controlled units, extensive glazing and an attractive lobby. Abbotsford is the fifth largest city in BC with approximately 180,000 people. Townhouse and condominium projects are located within blocks of this development. The City has a dynamic and vibrant business community that is continuing to expand. With excellent building signage and 30,000 plus vehicles per day on South Fraser Way, this is where your business needs to be!

[themarkabbotsford.com](http://themarkabbotsford.com)

**Contact:**

**604.510.5555**

Gordon MacPherson \*  
[gordon@fvcre.com](mailto:gordon@fvcre.com)

Ryan Schwartz \*  
[ryan@fvcre.com](mailto:ryan@fvcre.com)



RE/MAX Commercial Advantage  
#202 - 15127 - 100 Avenue  
Surrey, BC V3R 0N9

\* Personal Real Estate Corporation

Each Office is Independently Owned & Operated

For more information visit: [www.fvcre.com](http://www.fvcre.com)

*fraser valley*  
COMMERCIAL

# OFFICE FOR SALE

the mark



[themarkabbotsford.com](http://themarkabbotsford.com)

Contact:

**604.510.5555**

Gordon MacPherson \*  
[gordon@fvcre.com](mailto:gordon@fvcre.com)

Ryan Schwartz \*  
[ryan@fvcre.com](mailto:ryan@fvcre.com)



RE/MAX Commercial Advantage  
#202 - 15127 - 100 Avenue  
Surrey, BC V3R 0N9

\* Personal Real Estate Corporation

Each Office is Independently Owned & Operated

For more information visit: [www.fvcre.com](http://www.fvcre.com)



the mark



[themarkabbotsford.com](http://themarkabbotsford.com)

Contact:

**604.510.5555**

Gordon MacPherson \*  
gordon@fvcre.com

Ryan Schwartz \*  
ryan@fvcre.com



RE/MAX Commercial Advantage  
#202 - 15127 - 100 Avenue  
Surrey, BC V3R 0N9

\* Personal Real Estate Corporation

Each Office is Independently Owned & Operated

the mark

**NORTH BUILDING**  
32625 South Fraser Way

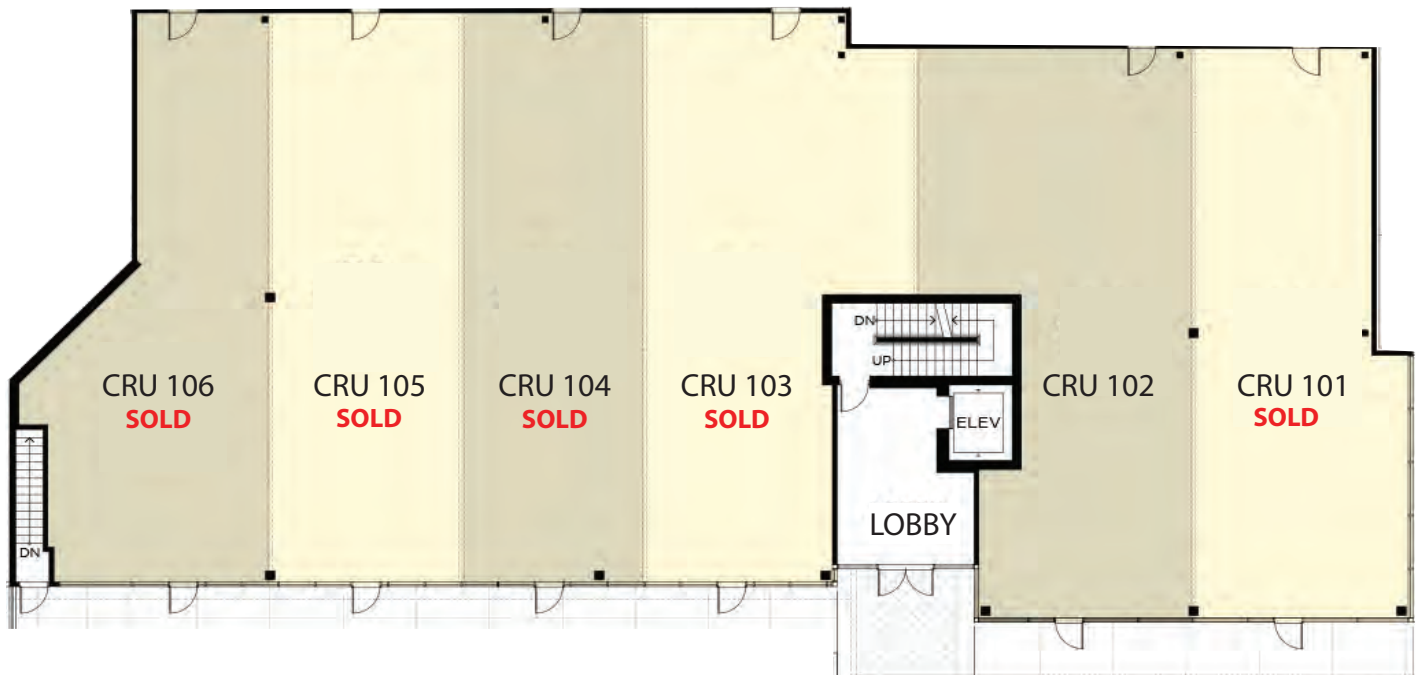

Ground Floor

[themarkabbotsford.com](http://themarkabbotsford.com)

Contact:

**604.510.5555**

Gordon MacPherson \*  
[gordon@fvcre.com](mailto:gordon@fvcre.com)

Ryan Schwartz \*  
[ryan@fvcre.com](mailto:ryan@fvcre.com)



RE/MAX Commercial Advantage  
#202 - 15127 - 100 Avenue  
Surrey, BC V3R 0N9

\* Personal Real Estate Corporation

Each Office is Independently Owned & Operated

the mark

**SOUTH BUILDING**  
32615 South Fraser Way

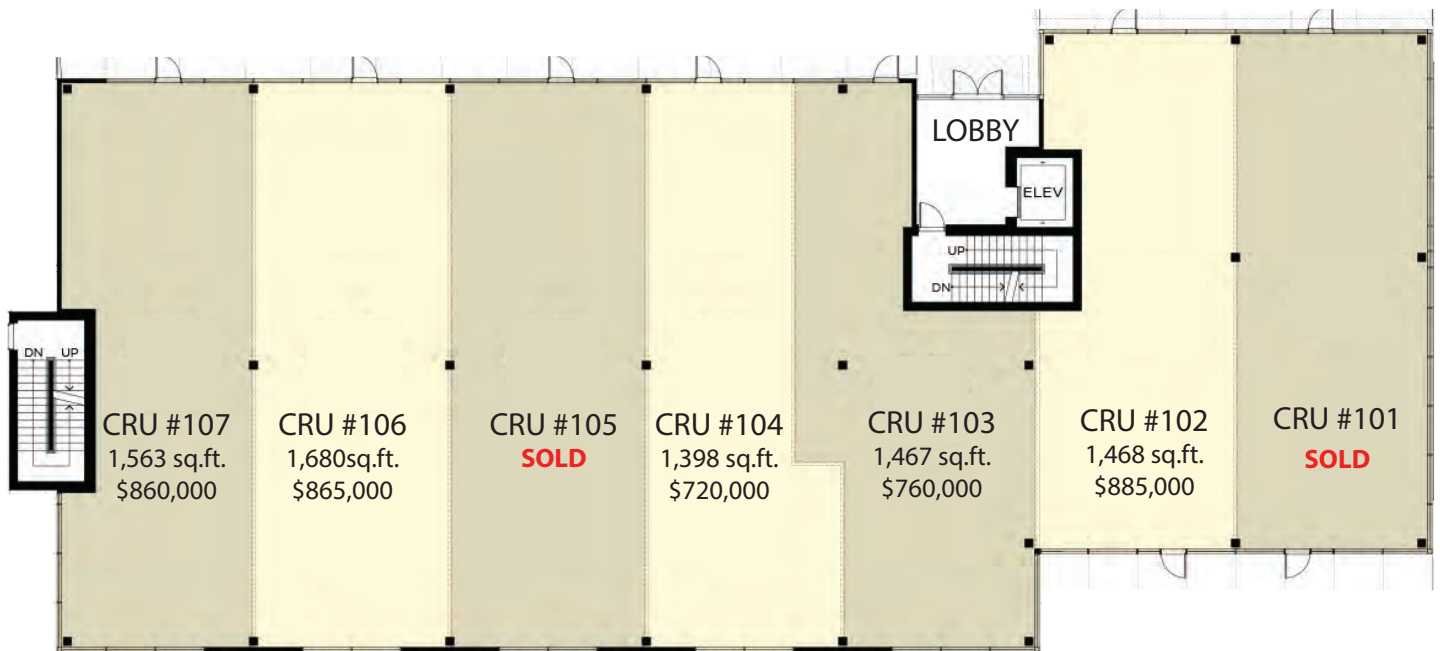

Ground Floor

[themarkabbotsford.com](http://themarkabbotsford.com)

Contact:

**604.510.5555**

Gordon MacPherson \*  
[gordon@fvcre.com](mailto:gordon@fvcre.com)

Ryan Schwartz \*  
[ryan@fvcre.com](mailto:ryan@fvcre.com)



RE/MAX Commercial Advantage  
#202 - 15127 - 100 Avenue  
Surrey, BC V3R 0N9

\* Personal Real Estate Corporation

Each Office is Independently Owned & Operated